

# CERMET

# Turning Insert

## WBGT

**Stocked Sizes:\***

- 1 = 1 Edge
- 2 = 2 Edges
- 3 = 3 Edges
- 4 = 4 Edges
- 6 = 6 Edges

**Blank Sizes:**

- X = 0.050 Depth of Cut
- Z = 0.100 Depth of Cut

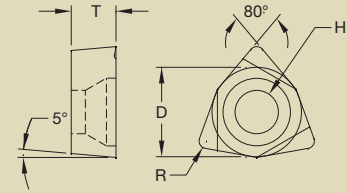
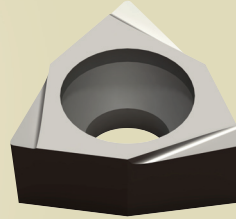

Type		Cermet Uncoated (Grades)				Cermet PVD Coated (Grades)				Dimensions (Inch)			
ANSI	ISO	CM340	CM360	CM380	CM400	CM440	CM460P	CM480P	CM500P	D	T	R	H
WBGT520.5L	WBGT020102									0.156	0.063	0.008	0.087
WBGT630.5L	WBGTS30202									0.188	0.094	0.008	0.091
WBGT631L	WBGTS30204									0.188	0.094	0.016	0.091

\* If Blank = Non-Stocked. Will produce to order.