

CERMET

Turning Insert

SNGG

Stocked Sizes:*

- 1 = 1 Edge
- 2 = 2 Edges
- 3 = 3 Edges
- 4 = 4 Edges
- 6 = 6 Edges

Blank Sizes:

- X = 0.050 Depth of Cut
- Z = 0.100 Depth of Cut

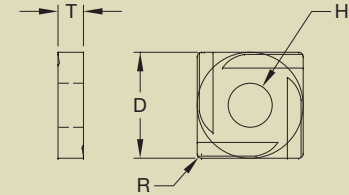
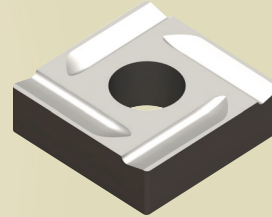

Type		Cermet Uncoated (Grades)				Cermet PVD Coated (Grades)				Dimensions (Inch)			
ANSI	ISO	CM340	CM360	CM380	CM400	CM440	CM460P	CM480P	CM500P	D	T	R	H
SNGG321R	SNGG090304									0.375	0.125	0.016	0.173
SNPR322R	SNPR090308									0.375	0.125	0.031	0.173
SNPR431R	SNPR120404									0.500	0.188	0.016	0.200
SNPR432R	SNPR120408									0.500	0.188	0.031	0.200
SNPR433R	SNPR120412									0.500	0.188	0.047	0.200
SNGG321L	SNGG090304									0.375	0.125	0.016	0.173
SNPL322L	SNPL090308									0.375	0.125	0.031	0.173
SNPL431L	SNPL120404									0.500	0.188	0.016	0.200
SNPL432L	SNPL120408									0.500	0.188	0.031	0.200
SNPL433L	SNPL120412									0.500	0.188	0.047	0.200

* If Blank = Non-Stocked. Will produce to order.